



ART • CULTURE • LEISURE

Imagine the dramatic effect of an urban industrial warehouse with towering, 16ft. walls, floor-to-ceiling windows facing out on 2nd Street in the heart of SoMa, exposed piping overhead, original hardwood floors, and monthly rotating art exhibitions showcasing edgy, contemporary works from street-influenced, urban-oriented artists.

Imagine 4,700 square feet of open space versatile enough to support two independent events—accommodating groups from 50–500, each space having a fully stocked bar, sound system and separate entrances.

Now imagine your event in this uniquely San Francisco setting and the unmistakable impression 111 Minna Gallery will leave on your guests.



LOCATION

SoMa (South of Market)

21+ NO EXCEPTIONS

STREET ADDRESS

111 Minna St. San Francisco, California 94105
(ground floor)

CAPACITY (Please see floor plan on page 6)

4,700 square feet with three rental configurations:
Entire space: 500 person capacity
Zappa Room: 200 person capacity
Second Street Gallery: 300 person capacity

EVENT SPACE

The space evokes the dramatic effect of an urban industrial warehouse with 16ft high walls, floor to ceiling windows facing out on 2nd Street, exposed piping overhead, original hardwood floors, and monthly rotating art exhibitions.

With 4,700 square feet of open space, 111 Minna Gallery can support two independent events—accommodating groups from 50-500. Each space has a fully stocked bar, sound system, separate entrances, and a raised stage.

EVENT USAGE

Corporate functions, social functions, product launches, press conferences, VIP/executive hosting, fundraising, dinners/luncheons, executive retreats/workshops. 111 Minna Gallery is also perfect for clients wishing to host events in conjunction with conferences at Moscone Center.

EVENT SERVICES

“Turn-key” venue/facilities/operations/staff available for premium facility fee, in-house catering, full audio/visual capabilities, event planning/production, décor/flowers, DJ services, photography, hosting, and security. In-house event planning company. We are here to help you with any of your event planning needs.

A/V CAPABILITIES

You're in good hands with our in-house audio/visual company, Sonic Zen Productions. Providing detailed professional attention throughout the planning and execution of your event, they can handle everything from a focused keynote presentation to an immersive product launch exhibition, to booking the perfect DJ or live band for your event.

111 Minna is equipped with a state of the art sound system spanning both rooms, two fully-stocked DJ booths, custom-configurable and adjustable gallery and stage lighting, gobo lights, and multiple ceiling-mounted video projectors. Additional sound reinforcement, staging, and lighting design, is all available. Technical info and details are available at <http://minna.soniczenproductions.com>

CREDIT CARDS

All major credit cards accepted

MANAGER CONTACT

MICHELLE DELANEY

Tel. 415.974.1719

Fax: 888.398.9278

MinnaCorporateEvents@gmail.com

111MINNAGALLERY.COM



photo: alexprellezo@gmail.com

ZAPPA ROOM (200 CAPACITY)





2ND STREET GALLERY (300 CAPACITY)



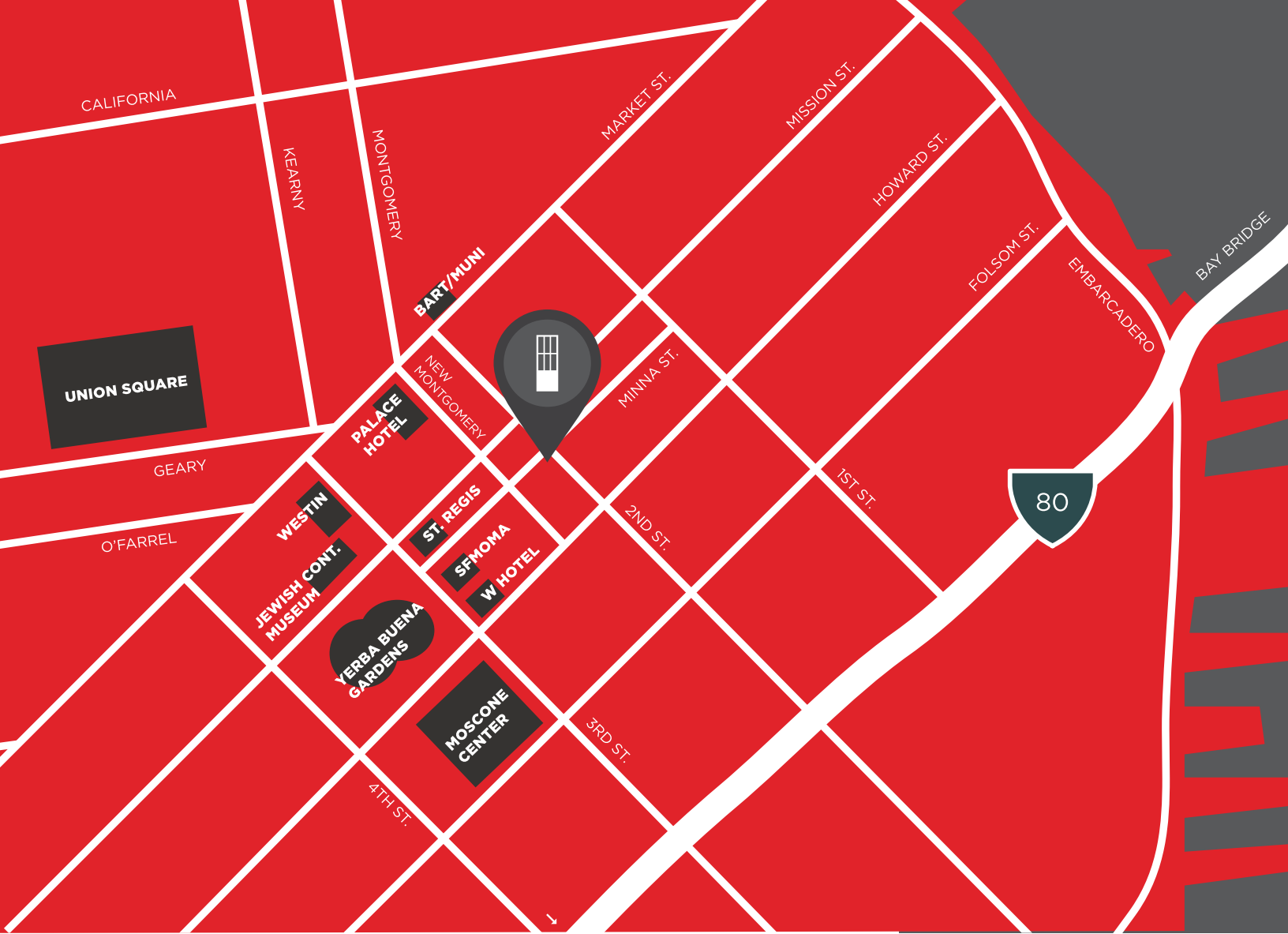

**WHERE WE ARE:
SOMA, SOUTH OF MARKET**

SoMa: South of Market, San Francisco's urban renewal district. The neighborhood is made up of a vast stretch of warehouses, nightclubs, art spaces, loft apartments and technology companies. The area around 2nd and Mission where 111 Minna is located, consists of Financial District overflow, convention goers and tourists and several major San Francisco art organizations.

**ACCOMMODATIONS NEAR
111 MINNA GALLERY**

111 Minna Gallery is delighted to offer clients and their guests deeply discounted room rates at two of Starwoods premiere hotels, the W Hotel San Francisco and the St. Regis San Francisco. Both are located in the heart of SoMa, within 2 blocks of the Gallery.

QUESTIONS?

Contact Direct:

W SAN FRANCISCO

181 Third Street
San Francisco, CA 94103
Tel: 415-777-5300
Fax: 415-817-7860

*Ask for "In-house" reservations or email 01153.Reservations@whotels.com with your reservation requests.

ST. REGIS SAN FRANCISCO

125 Third St.
San Francisco, CA 94103
Tel. 415-284-4000



RENTAL FEES

2nd Street Gallery Lounge (300 person capacity)
Zappa Room (200 person capacity).

EVENING RENTALS

2nd Street Gallery: Sunday through Wednesday, 5pm-9pm or 9pm-2am

Zappa Room: Sunday through Wednesday, 5pm-9pm or 9pm-2am

2nd Street Gallery: Thursday through Saturday, 5pm-9pm or 9pm-2am

Zappa Room: Thursday, 5pm-9pm or 9pm-2am

DAY RENTALS

111 Minna Gallery can be rented for day use from 6am to 5pm. Pricing is based on a 4-hour block of time.

2nd Street Gallery: Monday through Sunday—four-hour period

Zappa Room: Monday through Sunday—four-hour period



111 MINNA GALLERY

FLOORPLAN WITH DIMENSIONS
ALL DIMENSIONS ARE IN FEET
14' usable vertical space in the 2nd Street Gallery lounge's higher wall.
7' on the short walls.
13' usable vertical space in the Zappa Room.

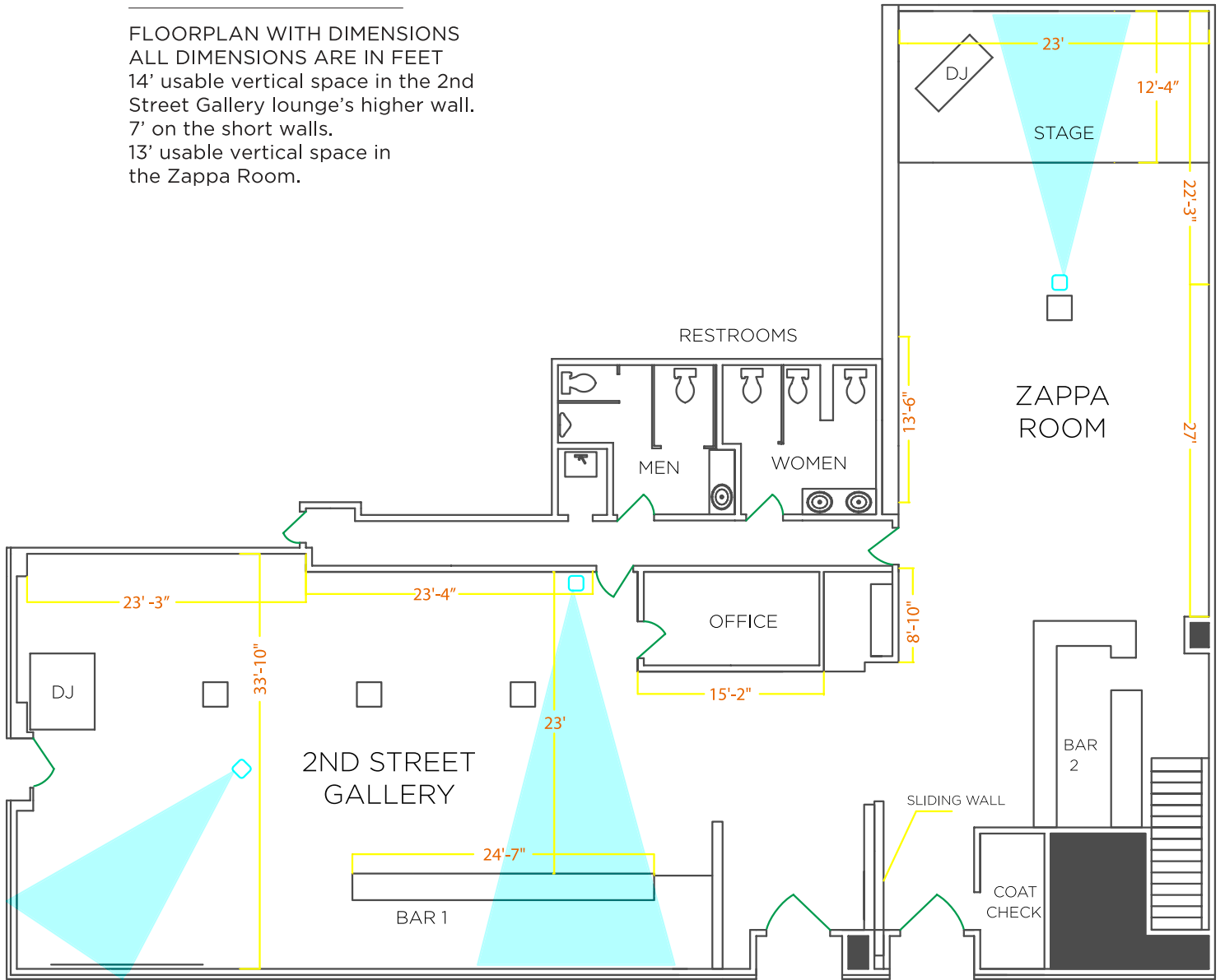



USES

Cocktail Receptions
Corporate Workshops & Classes
Fashion Shows
Weddings Reception
Film Screenings
Art Shows
Holiday Celebrations
CD and Design Launch Parties
Auctions
Political Fundraisers
Sample Sales
Photo Shoots
Concerts
Closed Media Events

CLIENTS

Google
Facebook
Rebecca Minkoff
Pandora
Benefit Cosmetics
Cisco Security Systems
Evernote
UC Berkeley
Teach for America
Intel
SF Weekly
Oracle
Save the Waves
Ubisoft
Aurora Feint
Pop Cap
Adam and Reese LLP
AAA
Dartmouth University
and many more...



CATERING AT 111 MINNA GALLERY

While 111 Minna clients are free to arrange their own catering, Minna Gallery has partnered with Foxtail Catering and Events to provide exceptional catering for all occasions. Whether it's passed hors d'oeuvres, platters, action stations or a seated dinner, Foxtail is able to bring the best seasonal, local and organic cuisine to your event offering custom menus ideal for diverse tastes and any size event.

111 Minna Gallery and Foxtail Catering work closely together to ensure that your guests are always impressed. Please feel free contact 111 Minna to set up a consultation or to see more menus.

EXAMPLE ACTION STATIONS

Housemade Flatbreads

A Variety of Housemade, Seasonal Flatbreads That May Include:
4-Cheeses, Roasted Tomato, Herbs, Caramelized Onion, Arugula, Reggiano, Goat Cheese, Artichoke

Pork Pie: *Sausage, Bacon, Pork Belly, Mushrooms, Peppers, Marinara*

Sliders: East vs. West and Beyond

Bahn Mi
House Pate, Seared Pork Belly, Cilantro Butter, Pickled Veggies, Baguette

Chipotle Barbeque Beef
Slow Braised Brisket with Smoked Chiles and Onions, Creamy Southern Slaw, Brioche Roll

"Buffalo" Chicken
Roasted Chicken, pulled and Tossed with Housemade Buffalo Sauce, Blue Cheese Butter, Celery Slaw

Deep Fried Portobello Cap
Lemon, Parsley, Caper, Shallot, Jalapeno Slaw

EXAMPLE HORS D'OEUVRES

Firecracker Prawns
Chipotle Battered and Deep Fried Prawns with Cilantro-Lime Aioli

Wild Mushroom Vol au Vent
Flaky Pastry, Wild Mushrooms, Goat Cheese, Tarragon

Mini Lamb Burger
Richly spiced Lamb with Tzaziki, Harissa, Cucumber and Feta on a Housemade Gougere

Pork Belly and Brioche Roulade
Pork Belly Confit and Brioche, Local Compote, Garnishes

Bruschetta with Traditional Flavors
Pt. Reyes Blue, French Butter and Red Pears, Treviso, Caramelized Balsamic, Da Vero EVO

YOUR EVENT

LET'S GET STARTED WITH SOME INFORMATION ABOUT YOU:

NAME _____

PHONE _____

EMAIL _____

COMPANY YOU ARE WITH _____

DATE YOU WOULD LIKE TO DO YOUR EVENT _____

TIME YOU WOULD LIKE TO DO YOUR EVENT (START & END) _____

TYPE OF EVENT (CLUB NIGHT, PRIVATE RECEPTION, BIRTHDAY PARTY, ETC.) _____

EVENT NAME _____

DOOR COVER CHARGE (IF APPLICABLE) _____

ESTIMATED ATTENDANCE _____

BRIEF DESCRIPTION OF EVENT _____

OTHER SPECIAL NEEDS/ REQUESTS _____
