



Eiming Jung founded 111 Minna Gallery and opened its doors in 1993 at 111 Minna Street in the SOMA district of San Francisco. This location would later become the heart of the up and coming art district, which has now been solidified with the construction of the SF MOMA, Yerba Buena Center for the Arts and countless progressive galleries emerging in the surrounding area.

With a business model focused on service and hospitality, patrons began to relish the visual aesthetics sourced from Bay Area artists, in conjunction with the laid back atmosphere that has long been associated with 111 Minna and its founder.

For many artists, 111 Minna quickly became the San Francisco gallery to exhibit their work and would grow to become an establishment, which would gain notoriety and an overall reputation for launching artist's careers, both nationally and internationally, while acting as host for a vast variety of art, specifically focused on underground, low brow, edgy and often times controversial. For the past eighteen years, 111 Minna has maintained its reputation for constant progression and positive energy and in so doing has become a cornerstone of San Francisco culture. As its twentieth year anniversary approaches, 111 Minna Gallery will build further

momentum in holding true to its roots, while displaying cutting edge art from talented emerging artists, as well as those firmly established.

The gallery also maintains its history of service to a number of charities and non-profit organizations, as well as the many people who consider it and its staff to be home and family.



111 MINNA GALLERY EVENT INFORMATION

LOCATION

SoMa (South of Market)

21+ NO EXCEPTIONS

STREET ADDRESS

111 Minna St. San Francisco, California 94105
(ground floor)

CAPACITY (Please see floor plan on page 6)

4,700 square feet with three rental configurations:
Entire space: 500 person capacity
Zappa Room: 200 person capacity
Second Street Gallery: 300 person capacity

EVENT SPACE

The space evokes the dramatic effect of an urban industrial warehouse with 16ft high walls, floor to ceiling windows facing out on 2nd Street, exposed piping overhead, original hardwood floors, and monthly rotating art exhibitions.

With 4,700 square feet of open space, 111 Minna Gallery can support two independent events—accommodating groups from 50-500. Each space has a fully stocked bar, sound system, separate entrances, and a raised stage.

EVENT USAGE

Corporate functions, social functions, product launches, press conferences, VIP/executive hosting, fundraising, dinners/luncheons, executive retreats/workshops. 111 Minna Gallery is also perfect for clients wishing to host events in conjunction with conferences at Moscone Center.

EVENT SERVICES

“Turn-key” venue/facilities/operations/staff available for premium facility fee, in-house catering, full audio/visual capabilities, event planning/production, décor/flowers, DJ services, photography, hosting, and security. In-house event planning company. We are here to help you with any of your event planning needs.

A/V CAPABILITIES

You’re in good hands with our in-house audio/visual company, Sonic Zen Productions. Providing detailed professional attention throughout the planning and execution of your event, they can handle everything from a focused keynote presentation to an immersive product launch exhibition, to booking the perfect DJ or live band for your event.

111 Minna is equipped with a state of the art sound system spanning both rooms, two fully-stocked DJ booths, custom-configurable and adjustable gallery and stage lighting, gobo lights, and multiple ceiling-mounted video projectors. Additional sound reinforcement, staging, and lighting design, is all available. Technical info and details are available at <http://minna.soniczenproductions.com>

CREDIT CARDS

All major credit cards accepted

MANAGER CONTACT

MICHELLE DELANEY

Tel. 415.974.1719

Fax: 888.398.9278

MinnaCorporateEvents@gmail.com

111MINNAGALLERY.COM



ZAPPA ROOM (200 CAPACITY)



2ND STREET GALLERY (300 CAPACITY)

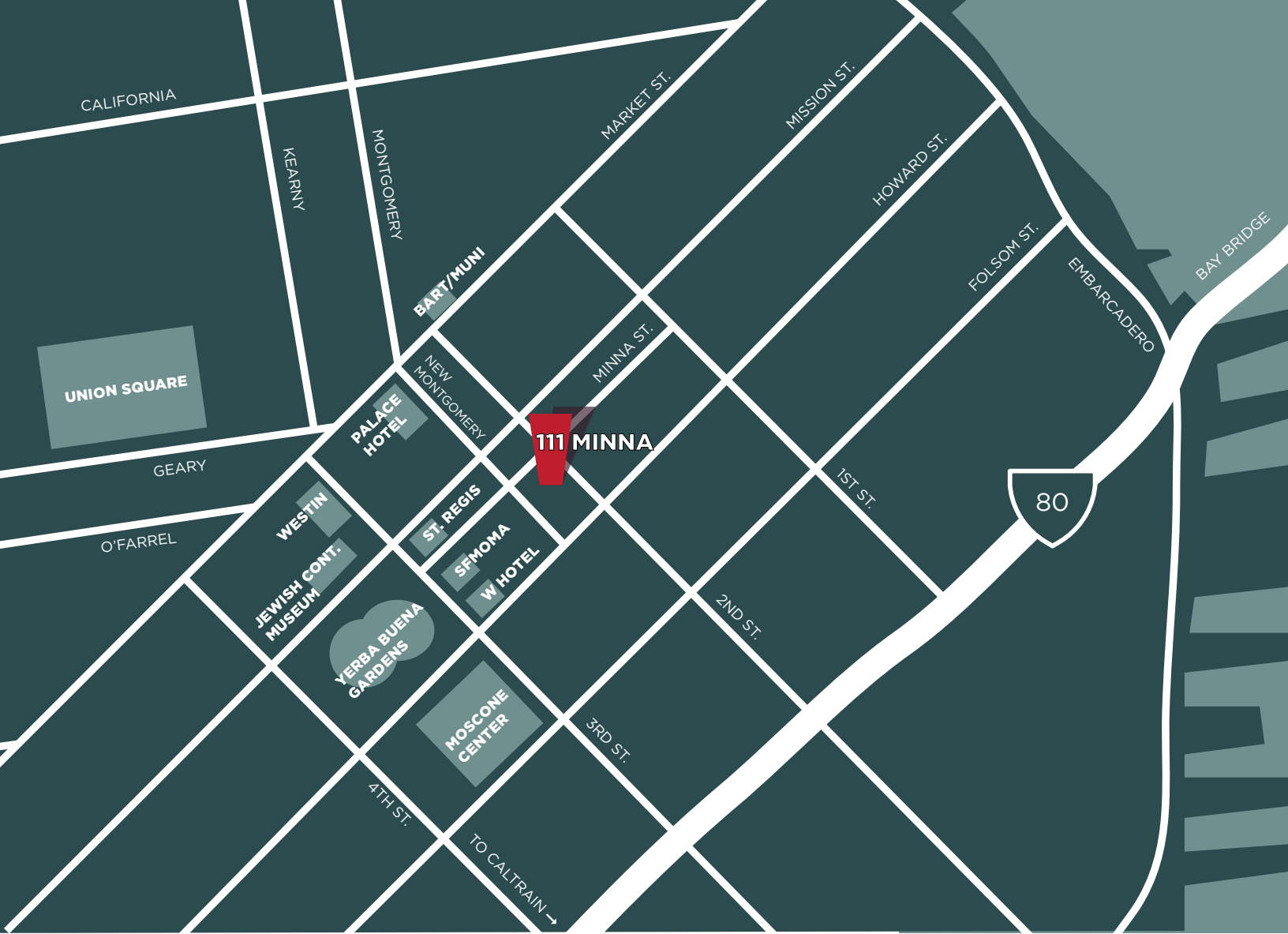

**WHERE WE ARE:
SOMA, SOUTH OF MARKET**

SoMa: South of Market, San Francisco's urban renewal district. The neighborhood is made up of a vast stretch of warehouses, nightclubs, art spaces, loft apartments and technology companies. The area around 2nd and Mission where 111 Minna is located, consists of Financial District overflow, convention goers and tourists and several major San Francisco art organizations.

**ACCOMMODATIONS NEAR
111 MINNA GALLERY**

111 Minna Gallery is delighted to offer clients and their guests deeply discounted room rates at two of Starwoods premiere hotels, the W Hotel San Francisco and the St. Regis San Francisco. Both are located in the heart of SoMa, within 2 blocks of the Gallery.

QUESTIONS?

Contact Direct:

W SAN FRANCISCO
 181 Third Street
 San Francisco, CA 94103
 Tel: 415-777-5300
 Fax: 415-817-7860
 *Ask for "In-house" reservations or email 01153.Reservations@whotels.com with your reservation requests.

ST. REGIS SAN FRANCISCO
 125 Third St.
 San Francisco, CA 94103
 Tel. 415-284-4000



RENTAL FEES

2nd Street Gallery Lounge (300 person capacity)
Zappa Room (200 person capacity).

EVENING RENTALS

2nd Street Gallery: Sunday through Wednesday, 5pm-9pm or 9pm-2am

Zappa Room: Sunday through Wednesday, 5pm-9pm or 9pm-2am

2nd Street Gallery: Thursday through Saturday, 5pm-9pm or 9pm-2am

Zappa Room: Thursday, 5pm-9pm or 9pm-2am

DAY RENTALS

111 Minna Gallery can be rented for day use from 6am to 5pm. Pricing is based on a 4-hour block of time.

2nd Street Gallery: Monday through Sunday—four-hour period

Zappa Room: Monday through Sunday—four-hour period



111 MINNA GALLERY

FLOORPLAN WITH DIMENSIONS
ALL DIMENSIONS ARE IN FEET
14' usable vertical space in the 2nd Street Gallery lounge's higher wall.
7' on the short walls.
13' usable vertical space in the Zappa Room.

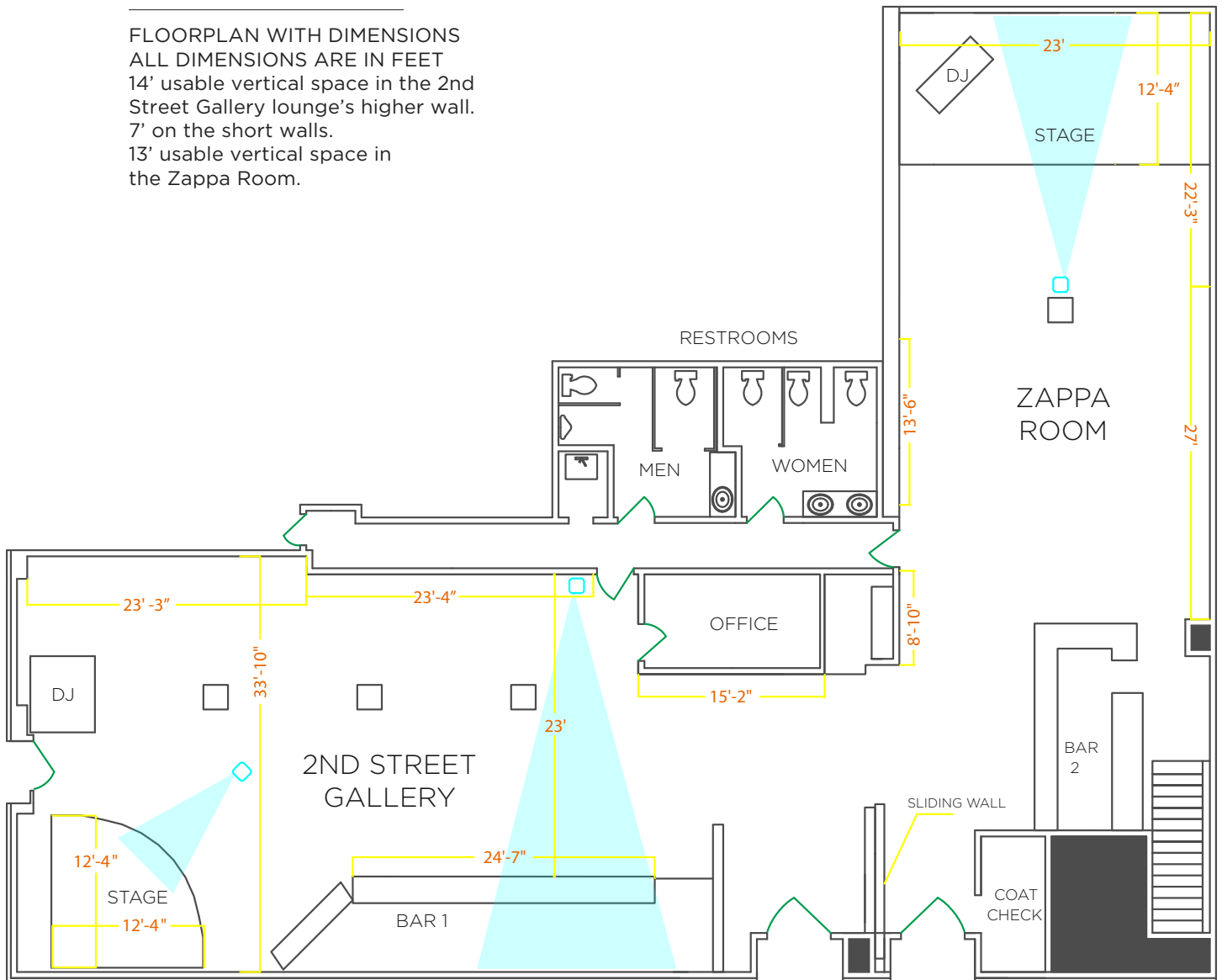



USES

Cocktail Receptions
Corporate Workshops & Classes
Fashion Shows
Weddings Reception
Film Screenings
Art Shows
Holiday Celebrations
CD and Design Launch Parties
Auctions
Political Fundraisers
Sample Sales
Photo Shoots
Concerts
Closed Media Events

CLIENTS

Google
Facebook
Rebecca Minkoff
Pandora
Benefit Cosmetics
Cisco Security Systems
Evernote
UC Berkeley
Teach for America
Intel
SF Weekly
Oracle
Save the Waves
Ubisoft
Aurora Feint
Pop Cap
Adam and Reese LLP
AAA
Dartmouth University
and many more...

CATERING AT 111 MINNA GALLERY

While Minna clients are free to arrange their own catering, Minna Gallery has partnered with The Pheonix Supper Club to offer exceptional catering for every occasion from platters and hors d'oeuvres to seated dinners, ideal for diverse tastes and any size event.

SAMPLE HORS D'OEUVRES

from the **Pheonix Supper Club**

"Caprese" Skewers

Cherry Tomato, Fresh Mozzarella, Balsamic, Basil

Ahi Tartare

With Preserved Lemon, Shallots, and Capers

Beet and Goat Cheese Lollipops

Roasted Red and Gold Beets, Redwood Hill Chevre, Basil, Balsamic Reduction, Sea Salt

Crab Rolls

Fresh Dungeness Crab, Toasted Brioche, Celery, Lemon Aioli, Shallot, Chive

Grilled Citrus Prawn

Grilled Prawn, Preserved Lemon Relish, Citrus Aioli, Sea Salt

Roasted Vegetable Crostini

Roasted Seasonal Vegetables, Herbed Mascarpone, Lemon, Champagne Vinaigrette

Rock Shrimp Ceviche

Rock Shrimp, Avocado, Cilantro, Jalapeno and Habanero Brunoise, Toasted Corn Nut, Orange and Lime



Other preferred caterers include the renowned Roy's Hawaiian Fusion Cuisine and the local community favorite, Bi-Rite serving up fresh fare from their own market and sweets from their own creamery.

111 Minna Gallery works closely with our caterers to ensure your guests are impressed and you can feel like a guest at your own event.



YOUR EVENT

LET'S GET STARTED WITH SOME INFORMATION ABOUT YOU:

NAME _____

PHONE _____

EMAIL _____

COMPANY YOU ARE WITH _____

DATE YOU WOULD LIKE TO DO YOUR EVENT _____

TIME YOU WOULD LIKE TO DO YOUR EVENT (START & END) _____

TYPE OF EVENT (CLUB NIGHT, PRIVATE RECEPTION, BIRTHDAY PARTY, ETC.) _____

EVENT NAME _____

DOOR COVER CHARGE (IF APPLICABLE) _____

ESTIMATED ATTENDANCE _____

BRIEF DESCRIPTION OF EVENT _____

OTHER SPECIAL NEEDS/ REQUESTS _____



Tel.: 415.974.1719

SAN FRANCISCO

111 MINNA GALLERY